

Standard Preparation 1200 mm Sink with 1 Bowl & Right Drain

ITEM # _____

MODEL # _____

NAME # _____

SIS # _____

AIA # _____

**133191 (NSBD1217R)**

Sink unit for undercounter dishwasher with 1 bowl W400xD500xH300mm and right hand drainer, 1200mm

Short Form Specification

Item No. _____

Made from 304 AISI stainless steel. The 50mm high worktop in 304 AISI stainless steel, 1mm in thickness, is sound-deadened and has an overflow rim and welded corners. Integral rear upstand, h=100mm, with 10mm radius. Allround apron. Square section legs 40x40mm on 1" height-adjustable feet (+/-20mm). Bowl W400xD500xH300mm with overflow pipe and 2" drain hole; right hand drainer. An undercounter dishwasher can be placed under the drainer.

Main Features

- Sturdiness, stability and reliability of table accurately tested.

Construction

- 50 mm worktop in 304 AISI stainless steel, 10/10 in thickness with overflow rim along the top.
- 100 mm upstand with 8 mm radiused corner and 13 mm deep, designed to be used against a wall.
- Square section legs and 40 mm height-adjustable feet in 304 AISI stainless steel.
- Sink tops easily slotted onto the legs and taps are easily installed from the rear.
- Bottom part of drain left free to house an undercounter dishwasher.
- Wide range of taps are available to suit every need.
- Drainage area suitable for drying operations
- 100 mm upstand with 10 mm radiused corner and 13 mm deep, designed to be used against a wall.

Optional Accessories

- Set of 4 wheels (2 with brake) PNC 855150 ☐
d. 100mm for tables and sinks
(total height on wheels= 993 mm)
- Elbow operated mixer tap with PNC 855322 ☐
spout, 3/4" single hole
- Elbow operated mixer tap short PNC 855323 ☐
spout, 3/4" single hole
- Foot operated Mixer tap with PNC 855328 ☐
spout & with hot&cold pedals,
3/4"
- Elbow operated mixer tap with PNC 855374 ☐
spout, 3/4" single hole
- Elbow operated mixer tap with PNC 855375 ☐
short spout, 3/4" single hole
- Single hole deck mounted PNC 855382 ☐
mixing temperature monoblock
faucet
- Single hole deck mounted extra PNC 855383 ☐
robust pot filling mixing
temperature faucet
- Single hole deck mounted PNC 855384 ☐
mixing temperature faucet with
short spout
- Single hole deck mounted PNC 855385 ☐
mixing temperature pre-rinse
unit
- Single hole deck mounted PNC 855386 ☐
elbow operated mixing
temperature faucet with pre-
rinse unit
- Single hole deck mounted riser PNC 855387 ☐
add-on mixing temperature
faucet with pre-rinse unit

APPROVAL: _____

- Single hole deck mounted elbow operated mixing temperature faucet with short pre-rinse unit PNC 855388 ☐
- Single hole deck mounted riser add-on mixing temperature faucet with pre-rinse unit PNC 855389 ☐
- Single hole deck mounted mixing temperature faucet with pre-rinse unit PNC 855390 ☐
- Floor fastening kit for 2 square legs PNC 865386 ☐
- Single plastic drain syphon 2" for sinks PNC 895313 ☐

Standard Preparation 1200 mm Sink with 1 Bowl & Right Drain

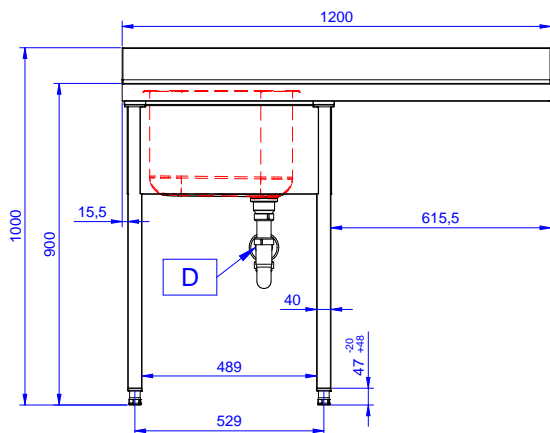
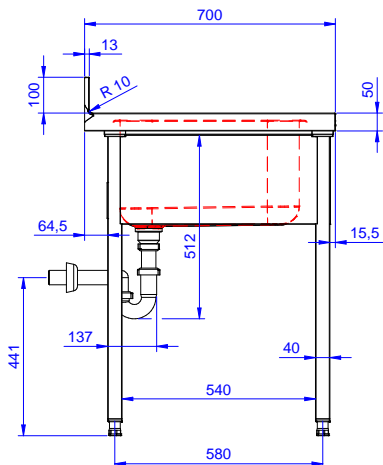
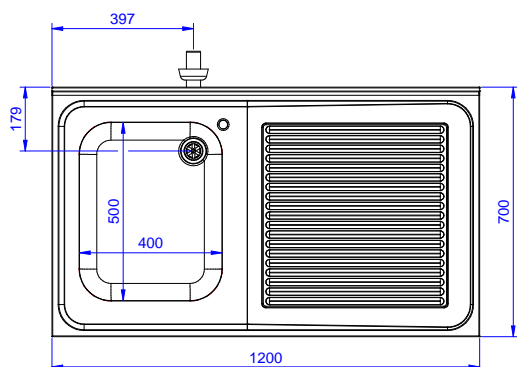
Front

Side

Top

Key Information:
External dimensions, Width:

133191 (NSBD1217R) 1200 mm

External dimensions, Depth:

700 mm

External dimensions, Height:

1000 mm

Upstand Dimensions, Height:

100 mm

Upstand Dimensions, Depth:

13 mm

Upstand Dimensions, Radius:

R=10

Bowls number

1

Bowl dimensions

400x500xH320

Worktop thickness:

0 mm

Net weight:

32.3 kg

**Standard Preparation
1200 mm Sink with 1 Bowl & Right Drain**

The company reserves the right to make modifications to the products without prior notice. All information correct at time of printing.

2025.04.18